



Dassia Close Gidea Park

£1,850 PCM

**** NEW BUILD**** APS have pleasure in offering this 2 bedroom apartment which has been meticulously designed and finished to the highest standard and is located within easy reach of Gidea Park Queen Elizabeth Line Station and local amenities. The property boasts a bespoke designed kitchen with Quartz work surfaces, integrated appliances (including fridge-freezer, washing machine & dishwasher), open plan living space and a contemporary fitted bathroom suite with designer vanity units. Other benefits include double glazing, air source underfloor heating, video door entry for communal door, private garden and allocated parking. Available 13th December 2024. (Council Tax Band D)

- NEW BUILD PROPERTY
- MODERN FITTED KITCHEN
- CONTEMPORARY FITTED BATHROOM
- UNDER FLOOR HEATING
- DOUBLE GLAZING
- VIDEO DOOR ENTRY FOR COMMUNAL DOOR
- PRIVATE GARDEN
- CLOSE TO STATION
- PARKING

Viewing

Please contact our Alternative Property Services Limited Office on 01708 454121

if you wish to arrange a viewing appointment for this property or require further information.



2



1



1



B



Area Map

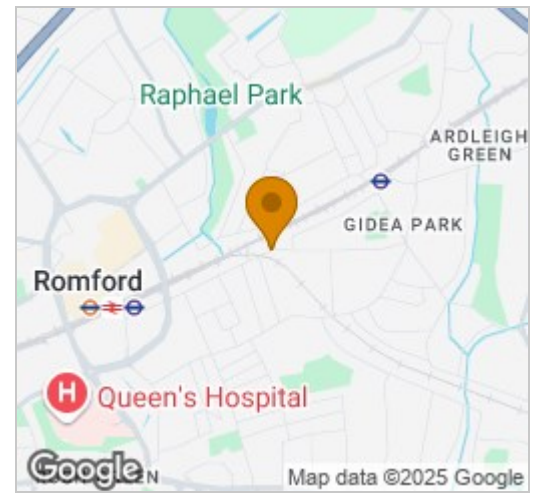

Energy Efficiency Graph

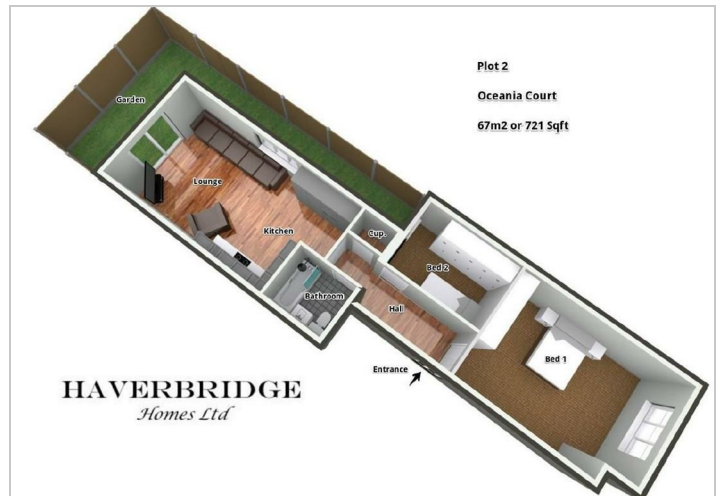
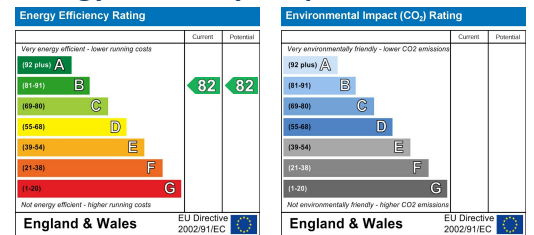

These particulars, whilst believed to be accurate are set out as a general outline only for guidance and do not constitute any part of an offer or contract. Intending purchasers should not rely on them as statements of representation of fact, but must satisfy themselves by inspection or otherwise as to their accuracy. No person in this firm's employment has the authority to make or give any representation or warranty in respect of the property.

4 North Street, Hornchurch, Essex, RM11 1QX

Tel: 01708 454121 Email: lettings@alternativepropertyservices.co.uk <https://www.alternativepropertyservices.co.uk>